

TECHNIK FÜR SICHERHEIT UND UMWELT

SAFETY AND ENVIRONMENTAL TECHNOLOGY

Magnettauchsonden der Typenreihe T-20...

Typenschlüssel

Grundbezeichnung

Rohrdurchmesser

- 0 = Rohr Ø 16 mm
- 1 = Rohr Ø 15 mm
- 2 = Rohr Ø 12 mm
- 5 = Rohr Ø 8 mm
- 6 = Rohr Ø 8 mm, gebogen
- 7 = Rohr Ø 8 mm, langes Gewinde
- 8 = Rohr Ø 20 mm
- 9 = Rohr Ø 18 mm

Material Rohr und Verschraubung

- PE = Polyethylen
- PP = Polypropylen
- PV = Polyvinylchlorid
- PVDF = Polyvinylidenfluorid
- VA = Edelstahl 1.4571
- PT = Edelstahl, Rohr PTFE-beschichtet

Gewinde

- I1/8" = G 1/8" für Innenmontage
- I3/8" = G 3/8" für Innenmontage
- I1/4" = G 1/4" für Innenmontage
- I1/2" = G 1/2" für Innenmontage
- I1" = G 1" für Innenmontage
- A1/2" = G 1/2" für Außenmontage
- A1" = G 1" für Außenmontage
- A11/4" = G 1 1/4" für Außenmontage
- A11/2" = G 1 1/2" für Außenmontage
- A2" = G 2" für Außenmontage
- A3" = G 3" für Außenmontage
- S = Sonderwunsch

Ausführung

- ohne Angabe = fest
- V = verstellbar (nur bei Außengewinde)

Zusätzliche kontinuierliche Messkette

- ohne Angabe = keine
- K = kontinuierliche Messkette (ab Rohr Ø 12 mm)

Anzahl Schwimmer

- 1x = 1 Schwimmer
- 2x = 2 Schwimmer usw.

Schwimmerausführungen

- 03 = Kugel Edelstahl 52 mm Ø
- 04 = Kugel Edelstahl 62 mm Ø
- 05 = Oval Schwimmer Edelstahl 80 mm Ø
- 06 = Oval Schwimmer Edelstahl 94 mm Ø
- 07 = Kugel Edelstahl 105 mm Ø
- 08 = Zylinder Edelstahl 27 mm Ø
- 09 = Zylinder Edelstahl 44 mm Ø
- 10 = Zylinder PE 52 mm Ø
- 11 = Zylinder PE 78 mm Ø
- 12 = Zylinder PP 19 mm Ø
- 13 = Zylinder PP 25 mm Ø
- 14 = Zylinder PP 52 mm Ø
- 15 = Zylinder PP 78 mm Ø
- 16 = Zylinder PTFE 80 mm Ø
- 17 = Zylinder PVC 78 mm Ø
- 18 = Zylinder PVC 55 mm Ø
- 19 = Zylinder PVDF 52 mm Ø

Anschluss

- PO = Polyesterdose
- AA = Aluminiumdose
- ST = 3fach- oder 6fach-Stecker
- LY = ___ mm Kabel LiYY (Standard 1000 mm)
- SI = ___ mm Kabel Silikon (Standard 1000 mm)
- PT = ___ mm Litze PTFE 0,24 mm² (Standard 1000 mm)
- GF = Überwurfmutter 2 3/4"

Rohrlänge in mm

R = ___ mm

Schaltpunkte in mm

- K1 = ___ mm
- K2 = ___ mm usw.

Kontakte (Standard monostabil)

- NO = Schließer
- NC = Öffner
- WE = Wechsler

Kontaktverhalten

- ohne Angabe = monostabil
- bi = bistabil

Begrenzung

- (nur bei monostabilen Kontakten)
- oben = oben begrenzt
- unten = unten begrenzt
- 0 = ohne

für jeden
Schaltpunkt
angeben

Optional: SIL
„Safty Integrity Level“
1 = SIL 1



Immersible Magnetic Probes Type Series T-20...

Type Key

Basic designation

- 0 = pipe Ø 16mm
- 1 = pipe Ø 15mm
- 2 = pipe Ø 12mm
- 5 = pipe Ø 8mm
- 6 = pipe Ø 8mm, bent
- 7 = pipe Ø 8mm, long thread
- 8 = pipe Ø 20mm
- 9 = pipe Ø 18mm

Material of pipe and screw union

- PE = Polyethylene
- PP = Polypropylene
- PV = Polyvinylchloride
- PVDF = Polyvinylidene fluoride
- VA = Stainless steel 1.4571
- PT = Stainless steel, pipe PTFE-coated

Thread

- I1/8" = G 1/8" for internal assembly
- I3/8" = G 3/8" for internal assembly
- I1/4" = G 1/4" for internal assembly
- I1/2" = G 1/2" for internal assembly
- I1" = G 1" for internal assembly
- A1/2" = G 1/2" for external assembly
- A1" = G 1" for external assembly
- A11/4" = G 1 1/4" for external assembly
- A11/2" = G 1 1/2" for external assembly
- A2" = G 2" for external assembly
- A3" = G 3" for external assembly
- S = Special request

Design

- without indication = fixed
- V = adjustable (only with external thread)

Additional continuous immersible probes

- without indication = none
- K = continuous immersible probes (starting from pipe Ø 12 mm)

No. of Floats

- 1x = 1 float
- 2x = 2 floats etc.

Float Models

- 03 = ball Stainless steel 52 mm Ø
- 04 = ball Stainless steel 62 mm Ø
- 05 = oval float Stainless steel 80 mm Ø
- 06 = oval float Stainless steel 94 mm Ø
- 07 = ball Stainless steel 105 mm Ø
- 08 = cylinder Stainless steel 27 mm Ø
- 09 = cylinder Stainless steel 44 mm Ø
- 10 = cylinder PE 52 mm Ø
- 11 = cylinder PE 78 mm Ø
- 12 = cylinder PP 19 mm Ø
- 13 = cylinder PP 25 mm Ø
- 14 = cylinder PP 52 mm Ø
- 15 = cylinder PP 78 mm Ø
- 16 = cylinder PTFE 80 mm Ø
- 17 = cylinder PVC 78 mm Ø
- 18 = cylinder PVC 55 mm Ø
- 19 = cylinder PVDF 52 mm Ø

Connection

- PO = Polyester box
- AA = Aluminum box
- ST = Triple- or sixfold adaptor
- LY = ___ mm cable LiYY (standard 1000 mm)
- SI = ___ mm cable Silicone (standard 1000 mm)
- PT = ___ mm cable PTFE 0,24 mm² (standard 1000 mm)
- GF = sleeve nut 2 3/4"

Pipe length in mm

R = ___ mm

Switch points in mm

- K1 = ___ mm
- K2 = ___ mm etc.

Contacts (standard monostable)

- NO = NO
- NC = NC

Contact behavior

- without indication = monostable
- bi = bistable

Limiting

- (only for monostable contacts)
- oben = limited upwards
- unten = limited downwards
- 0 = without

provide data
for each
switch point

Optional: SIL
„Safty Integrity Level“
1 = SIL 1



TAUCHSONDEN • IMMERSIBLE PROBES

Anschlussdosen auf Außenverschraubung montiert Connection boxes mounted on external screw union

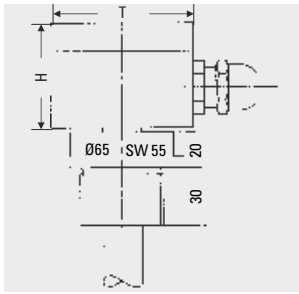

Typ / Type
 RMS-VPP(VPE)-A1 1/2''-AA(PO) = Rohr geschraubt
 Screw pipe
 RVA-VPP(VPE)-A1 1/2''-AA(PO) = Rohr geschraubt
 Screw pipe

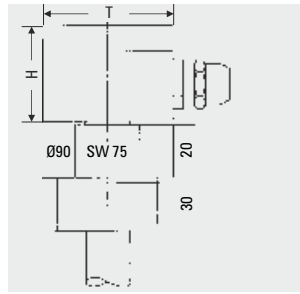

Typ / Type
 RPV-VPV-A2''-AA(PO) = Rohr geklebt
 Pipe glued
 RPP-VPP-A2''-AA(PO) = Rohr geschraubt
 Screw pipe
 RPT-VPT-A2''-AA(PO) = Rohr geklemmt
 Pipe clamped
 RPE-VPE-A2''-AA(PO) = Rohr geschweißt
 Pipe welded

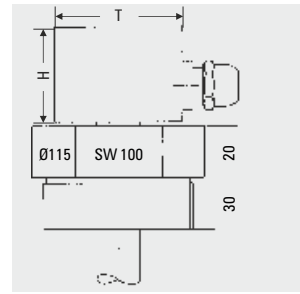

Typ / Type
 RPI-VPV-A3''-AA(PO) = Rohr geklebt
 Pipe glued
 RPP-VPP-A3''-AA(PO) = Rohr geschraubt
 Screw pipe
 RPT-VPT-A3''-AA(PO) = Rohr geklemmt
 Pipe clamped
 RPE-VPE-A3''-AA(PO) = Rohr geschweißt
 Pipe welded

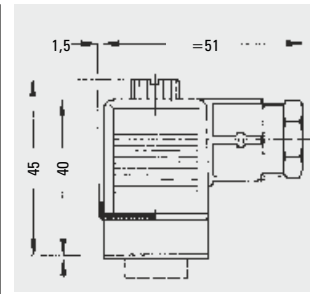

Anschlussstecker / Connection Plug

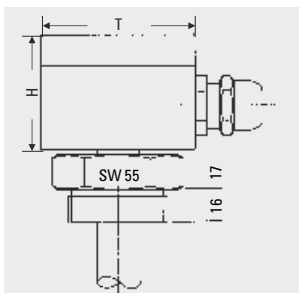

Typ / Type
 RMS-VMS-A1 1/2''-AA(PO) = Rohr hartgelötet
 Pipe brazed
 RVA-VMS-A1 1/2''-AA(PO) = Rohr geschraubt
 Screw pipe
 RMS-VVA-A1 1/2''-AA(PO) = Rohr geschraubt
 Screw pipe
 RVA-VVA-A1 1/2''-AA(PO) = Rohr geschweißt
 Pipe welded

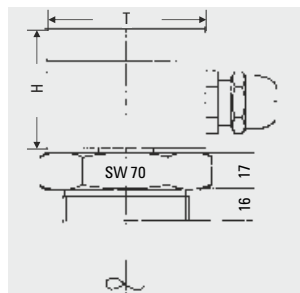

Typ / Type
 RMS-VMS-A2''-AA(PO) = Rohr hartgelötet
 Pipe brazed
 RVA-VMS-A2''-AA(PO) = Rohr geschraubt
 Screw pipe
 RMS-VVA-A2''-AA(PO) = Rohr geschraubt
 Screw pipe
 RVA-VVA-A2''-AA(PO) = Rohr geschweißt
 Pipe welded

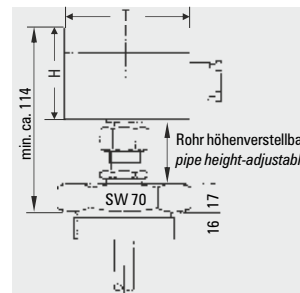

Typ / Type
 RMS-VMS-A2''-AA(PO)-V } = Fixierung mit
 RVA-VMS-A2''-AA(PO)-V } Schneidring
 RMS-VVA-A2''-AA(PO)-V } Secured with
 RVA-VVA-A2''-AA(PO)-V } tube union

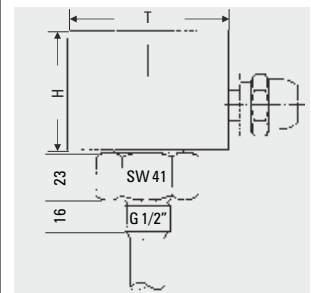

Typ / Type
 RMS-VMS-A 1/2''-AA(PO) = Rohr hartgelötet
 Pipe brazed
 RVA-VMS-A 1/2''-AA(PO) = Rohr geschraubt
 Screw pipe
 RMS-VVA-A 1/2''-AA(PO) = Rohr geschraubt
 Screw pipe
 RVA-VVA-A 1/2''-AA(PO) = Rohr geschweißt
 Pipe welded

Maße Anschlussdosen HxBxT in mm / Dimensions connector socket HxWxD in mm

Anzahl Klemmen / No. of clamps	bis / up to 6	bis / up to 12	bis / up to 18	über / over 18
Aluminium / Aluminum	54x80x75	54x125x80	54x175x80	54x175x80
Polyester / Polyester	55x80x75	55x110x75	55x160x75	55x190x75

Elektrische Anschlüsse / Electrical Connections

Wechsler / Change-over contact			Schließer/öffner NO/NC	
Kontakt Nr.	Anschlussdose Klemmenbezeichnung	Kabelschwanz Kabelfarbe	Anschlussdose Klemmenbez.	Kabelschwanz Kabelfarbe
Contact No.	Connection box Clamp name	Unconnected cable end Cable colour	Connection box Clamp name	Unconnected cable end Cable colour
K ₁	rot / red 1	weiß / white	1	weiß / white
	schwarz / black 2	braun / brown	2	braun / brown
	gelb / yellow 3	grün / green		
K ₂	rot / red 4	gelb / yellow	3	grün / green
	schwarz / black 5	grau / grey	4	gelb / yellow
	gelb / yellow 6	rosa / pink		
K ₃	rot / red 7	blau / blue	5	grau / grey
	schwarz / black 8	rot / red	6	rosa / pink
	gelb / yellow 9	schwarz / black		
K ₄	10		7	blau / blue
	11		8	rot / red
K ₅	12			
	13		9	schwarz / black
	14		10	violett / violet
K ₆	15			
			11	
K ₇			12	
			13	
			14	

Irrtümer und Änderungen vorbehalten.

Subject to change without prior notice, errors excepted.

Legende / Legend

Bemaßung in mm / Dimensioning in mm

- RVA = Edelstahlrohr / Stainless steel pipe
- RPE = PE-Rohr / PE pipe
- RPP = PPH-Rohr / PPH pipe
- RPT = Edelstahl-Rohr, PTFE beschichtet / Stainless steel pipe, PTFE-coated
- RPV = PVC-Rohr / PVC pipe
- VVA = Edelstahl-Verschraubung 1.4571 / Stainless steel union 1.4571
- VPE = PE-Verschraubung / PE union
- VPP = PPH-Verschraubung / PPH union
- VPT = PTFE-Verschraubung / PTFE union
- VPV = PVC-Verschraubung / PVC union
- A1 1/2'' = Gewinde G1 1/2'' für Außenmontage / Thread G1 1/2'' for external assembly
- A2'' = Gewinde G2'' für Außenmontage / Thread G2'' for external assembly
- A3'' = Gewinde G3'' für Außenmontage / Thread G3'' for external assembly
- AA = Aluminiumdose / Aluminum box
- PO = Polyesterdose / Polyester box
- V = Verstellbar / Adjustable

SIL
optional

Bemaßung in mm / Dimensioning in mm
 Fluid.iO-DB-240116-TOLI

